



UNIVERSAL SIDE FLOOR DRAINAGE
PSO50L - PSO50G - PSV75L - PSV75G
PSV50L - PSV50G - PSV110L - PSV110G

This product has been designed for channel rainwater and bring it into the outdoor road drainage system (s) and / or inside buildings. It is not designed to be used with domestic or industrial wastewater, or for use in transport communications.

ASSEMBLY PROCEDURE

The draining body (1) must be inserted in the exhaust pipe. Following the balancing on both axes, is necessary to cover the body (1) with the cover (2) to prevent the entry of foreign objects inside the body (1) and apply concrete (masonry) for stabilizing the body (1). At hardening occurred and once the screed has been executed pendant, remove the cap (2) and insert in the special hole the seal gasket (3). Then apply the waterproof sheet (4) placing it on the body (1) following the cuts of the fabric and the remainder of cloth that comes out of the body (1) glue it to the screed with adequate glue then insert the stainless steel flange (5) so that the arrow on it is oriented towards the exhaust duct then insert the 5 screws of stainless steel and fix everything. By doing so, it will permanently prevents leakage of water in critical situations. We recommend using the waterproofing sheet (4) and the stainless steel flange (5) in particular in multi-storey buildings. Insert the hydraulic siphon (6) with its cap (6), the sealing ring toroidal (7) in internal situations. Use the mechanical siphon (8) against odors provided with hinge (9) and sealing ring toroidal (10). We recommend using the mechanical siphon (8) in the presence of zones outside at frost risk. Subsequently cut the grid holder (11) to the height desired floor elevation and enter a discretion the o-ring (12) in the grid holder(11). Insert the filter (13). Before laying of the floors insert the cap for laying in work (14) and finally to completed floor and clean the stainless steel grid (15) by removing the protective film. During the assembly and masonry avoid bumps of sharp or hard objects. The product described complies with the requirements of the standard EN 1253 for load class K3.

N.B. the assembly procedure described it is indicated for waterproofing under tile having the cloth waterproofing (4) in fabric. If instead the required waterproofing is in sheath bituminous it is necessary to replace the cloth waterproofing (4) with the sheet in sheath bituminous art. TGB 50 X 50 (see price list LINEAR / PUNCTUAL 2019).

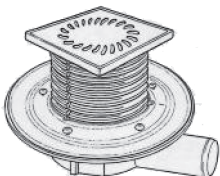
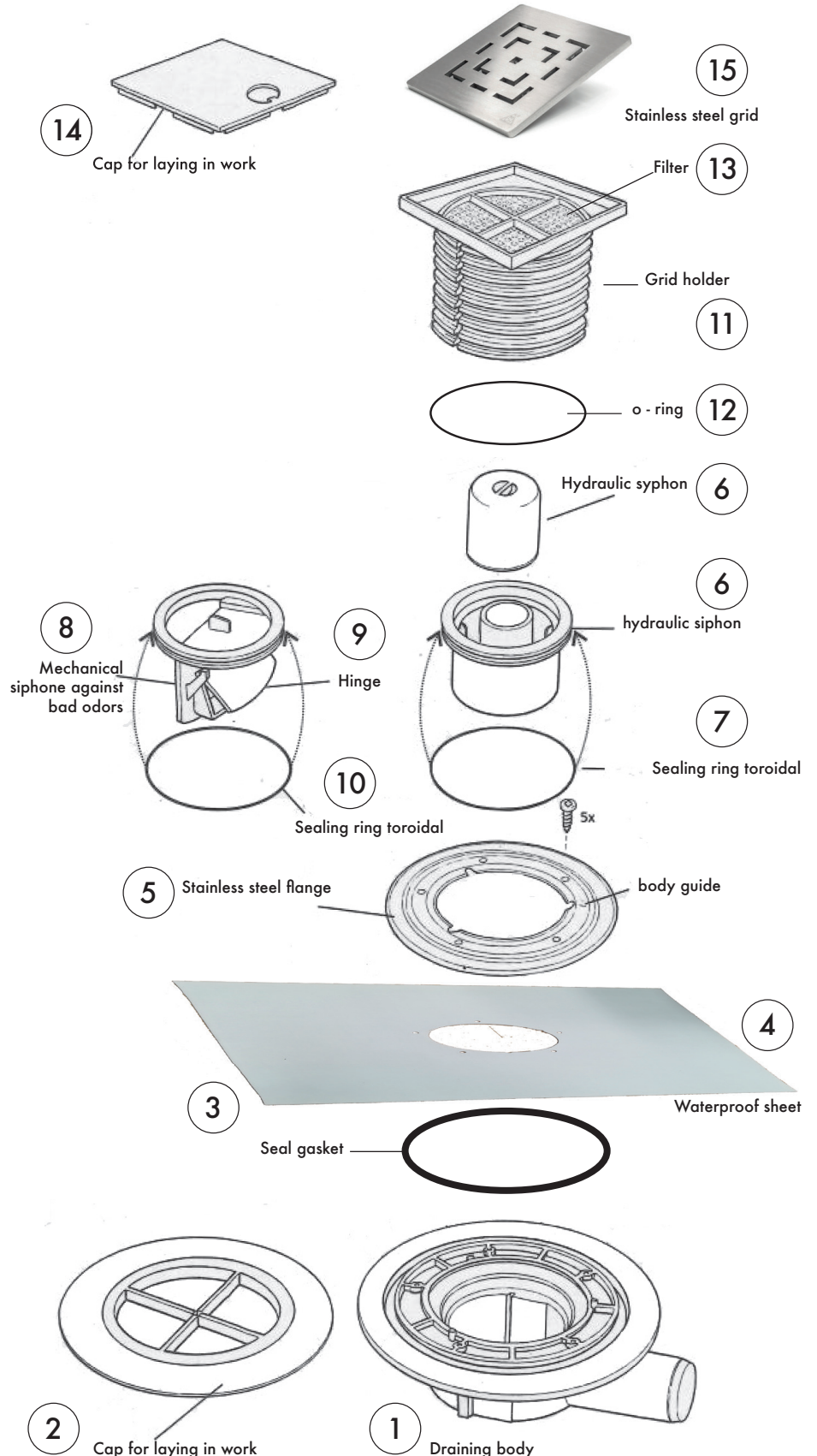

General conditions of Sale

SHIPPING At all times, the goods travel for the account of and at the risk of the Client even if shipped freight prepaid by any means and in any form. Any liability on our part ceases after loading. It will be the responsibility of the buyer to check the material prior to pick up, submitting any due claim to the competent party in the case of breakage, deterioration, tampering or material shortfall for which the Seller cannot be held liable.

ORDERS Commissions, modifications, collections, negotiations, rebates, transactions etc., made by agents or intermediaries are not valid without our confirmation in writing.

PRICES All prices are deemed at net, paid in cash for delivery ex-warehouse, unless otherwise agreed. The list prices in effect on the date of the order may be changed by us at any time. If between the date of ordering and the date of delivery, increases in raw material costs, labour, production, transportation expenses etc. occur, the Seller may increase the agreed price. However, if said price exceeds by 20% the price agreed at the time of ordering, the buyer may withdraw from the contract by issuing a notification via registered letter within and not later than 10 days from receipt of the notice of the price increase.

PAYMENTS Payments shall exclusively be made at our registered office.

DELIVERY

Delivery dates provided are always approximate.

Any delay or suspension in shipments due to strikes, faults, irregular provisions of raw materials, as well as any other case of force majeure under no circumstances shall give rise to claims for compensation or even partial termination of the contract.

RIGHT TO ISSUE BILLS OF EXCHANGE After 10 days from the due date of payment we shall have the right to issue a bill of exchange payable at sight covering the price and expenses. Such issuance shall be without notice.

RETENTION OF TITLE The goods are sold with agreement of retention of title pursuant to art. 1523 and following of the Italian Civil Code. Therefore until full payment of the price, including any interests payable and all ancillary expenses applicable, the goods shall remain our property.

INTERESTS ON LATE PAYMENTS Effective from the due date of payment, interests on late payments shall begin to accrue at the standard commercial rate in our favour

TERMINATION CLAUSE In the case of non-payment, even if partial on the material already supplied, and even if the buyer delays to issue payment, in any form, by 8 days, the seller shall be entitled to consider the contract terminated. Such termination shall consequently result in the seller's exemption from the obligation to carry out deliveries

not yet made. This is also valid in case of buyer's insolvency, even if merely apparent.

SOLVE ET REPETE Under no circumstances, including alleged faults or defects of material, the buyer may suspend or delay payment for the material received, except the right to request reimbursement when the buyer can demonstrate to have unduly paid.

CLAIMS AND WARRANTY No claims are accepted if not filed directly to us within 5 days from receipt of the goods at their destination. The buyer who filed claims within the deadline shall make available to the seller for inspection the entire material received and whenever faults and defects are confirmed, the buyer shall be entitled solely to the replacement of the defective materials with the exclusion of any claims for damages. Any compensation shall not exceed the value of the goods invoiced in addition to related transportation costs. Claims for materials already installed are not accepted. Each installation of the material, even if partial, constitutes acceptance of the goods as conforming to what was stated in the order. Under no circumstances the Seller's liability may be extended to the buyer's intended use of the product. This is valid even if we provide suggestions or advice regarding product installation. No warranties are extended beyond those deriving from the description of the goods as specified in the confirmation of order, catalogues and business documentation. No implicit warranties or warranties related to the suitability of the product for a particular use are provided and the buyer acknowledges that the goods are sold "as is". Any returns shall be accepted only after our authorization and only the transportation costs shall be borne by us, excluding any other charge.

EXPIRATION OF WARRANTY The buyer shall carefully inspect the goods upon receipt, opening the packaging. If any apparent faults are present that fall within the terms of the warranty, the buyer shall submit a claim by registered letter addressed directly to us within a mandatory term of five days from receipt of the material. After such deadline, the warranty for any faults that may be deemed apparent by an expert shall become null and void. If the buyer filed a claim within the deadline, the buyer shall make available to us for inspection the entire batch of material received. In the event that only a portion of such batch is made available to us, the warranty shall become null and void.

COURT OF JURISDICTION AND APPLICABLE LAW For any dispute that may arise, the Court of Jurisdiction shall be exclusively the Court of Rimini. This is valid also for goods sold with prepaid delivery as well as in the case of payments through bank drafts, bills of exchange or out-of-town checks.

Use and Maintenance Instructions

- Carefully follow the instructions that come with the products.
- The products have been designed for domestic use, thus limitations of use apply.
- Run hot water only for short periods of time, at a maximum temperature of 90°C.
- Do not use chemical cleaners to remove any deposits inside the channel.
- The stainless steel surfaces, exposed to the environmental elements or aggressive substances, should be cleaned periodically using a mild cleaning product. Regular cleaning not only gives the stainless steel a shiny appearance, but also prevents corrosion. The cleaning product must be free of hydrochloric and hydrofluoric acid.
- Avoid contact with other metals, such as for example non-stainless steel, since contact may cause rusting. The same is valid for the use of tools such as spatulas or steel wool, used to clean mortar, glue and stucco.
- The channel system is suitable to achieve waterproofing with liquid primers or insulation compounds for thin-bed installations.
- To correctly design and choose the appropriate channel system,

it is necessary to know the square meters that the channel system must drain so that the proper channel size for the application can be determined.

- Periodic maintenance of the channel is recommended to avoid accumulation of dirt inside it.
- The product is sensitive to certain petrol by-products.
- The product certifications can be viewed on the website www.canalainfinity.com

Important Note: Malagrida Group reserves the right to modify the specifications contained herein without prior notice, being the information provided purely indicative and subject to change based on product development. Furthermore, the instructions contained in this technical data sheet stem from our installation experience and must be considered purely indicative and to be confirmed by detailed practical applications. Therefore, those who use the product will have to assess whether it is suitable for the intended use and will assume any liability that may arise from such use.